

[SLFV - 96] Flash Vessel



SLFV-96 is an excellent designed flash vessel in carbon steel construction.

SIZE

150NB, 200NB, 300NB, 400NB, 450NB, 500NB

CERTIFICATION

- IBR / Non IBR
- En 10204 - 3.1

DESIGN CONDITIONS

- Max. Allowable Pressure (PMA) - 20 Kg/cm² (g) @ Room Temperature
- Max. Allowable Temp (TMA) - 425°C
- Max. Operating Pressure (PMO) - 14 Kg/cm² (g) @ 200°C

UNIQUE FEATURES

- Lifting lug as a standard feature for ease of installation.
- Designed as per standard section VIII.

INSTALLATION

- Install pressure gauge, safety valve, strainer, float trap, piston valve in loose condition with vessel as per construction view shown in the product catalogue.

[SLFV - 96] FLASH VESSEL

CONSTRUCTION

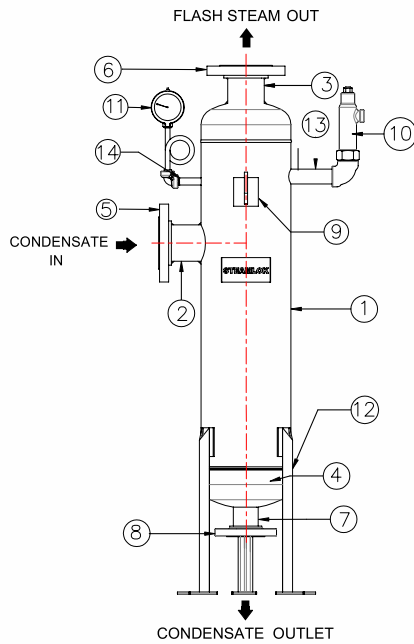

DIMENSIONAL VIEW

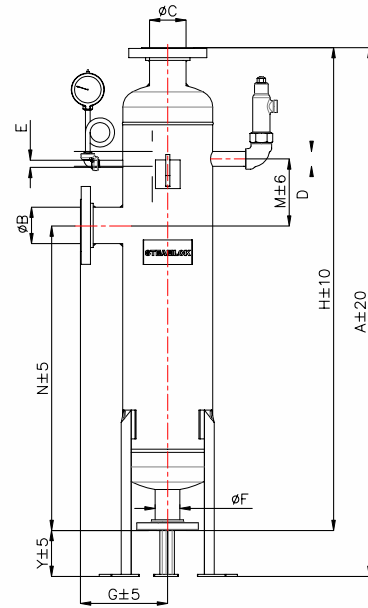

PART LIST

NO.	DESCRIPTION	MATERIAL	QTY
1	SHELL PIPE	ASTM A106 GR.B	1
2	CONDENSATE INLET PIPE	ASTM A106 GR.B	1
3	FLASH STEAM OUTLET PIPE	ASTM A106 GR.B	1
4	DISH END	ASTM A234 GR. WPB	2
5	CONDENSATE INLET PIPE FLANGE	ASTM A516 GR. 70	1
6	CONDENSATE OUTLET PIPE FLANGE	ASTM A516 GR. 70	1
7	CONDENSATE OUTLET PIPE	ASTM A106 GR.B	1
8	CONDENSATE OUTLET PIPE FLANGE	ASTM A516 GR. 70	1
9	LIFTING LUG	MS	2
10	SAFETY VALVE	GM/BRONZE	1
11	PRESSURE GAUGE WITH SYPHON	AISI 304	1
12	LEG SUPPORT	MS	3
13	PIPE NIPPLE TO PRESS. GAUGE	ASTM A106 GR.B	1
14	PIPE NIPPLE TO SAFETY VALVE	ASTM A106 GR.B	1

DIMENSIONS TABLE

SIZE NB	A	B NB	C NB	D NB	E NB	F NB	G	H	M	N	Y
150	1350	80	80	25	15	50	187	1165	195	720	60
200	1350	80	80	25	15	50	212	1200	195	750	150
300	1540	100	100	40	15	50	310	1320	254	750	220
400	1600	100	100	50	15	50	325	1342	195	750	258
450	1850	150	150	50	15	50	390	1506	220	770	344
500	2100	200	200	50	15	50	442	1802	370	856	298

Notes : All Dimensions are in mm.

HOW TO ORDER

Ex. SLFV-96, Carbon steel flash vessel, 150NB, flanged connection, Non IBR.



Steamlok Engineering Private Limited

Factory : W75, S-Block, MIDC Bhosari, Pune (MH) 411 026, India

Email : sales@steamlokengineering.com

Web : www.steamlok.com | www.steamlok.co.in