

# STEAMLOK ENGINEERING

[ SLSEP - 25 ]

## MOISTURE SEPARATOR



Steamlok



### SLSEP-25 is a Baffle Type Moisture Separator in cast steel (WCB) construction.

#### SIZE

25 NB, 40 NB, 50 NB, 65 NB, 80 NB, 100 NB, 125 NB, 150 NB, 200 NB

#### PIPE CONNECTIONS

Flanged : ASA150 ASA300

#### UNIQUE FEATURES

- Baffle type construction for enhanced condensate removal efficiency
- Suitable for both steam as well as compressed air

#### INSTALLATION

- Moisture separator has to be installed in horizontal direction as per arrow direction on body
- Condensate drain hole has to be at bottom side ( Pointing towards ground) Suitable trap or trap module need to install at condensate drain pipe to remove condensate

#### DESIGN CONDITIONS

Material Grade	End Connection	Max. Allowable Pressure ( PMA ) bar (g)	Max. Allowable Temperature degree centigrade
Cast Steel	#150	19.6	-29 to 38
		5.5	425
	#300	51.1	-29 to 38
		28.8	425

#### CERTIFICATION

IBR approval / En10204 3.1

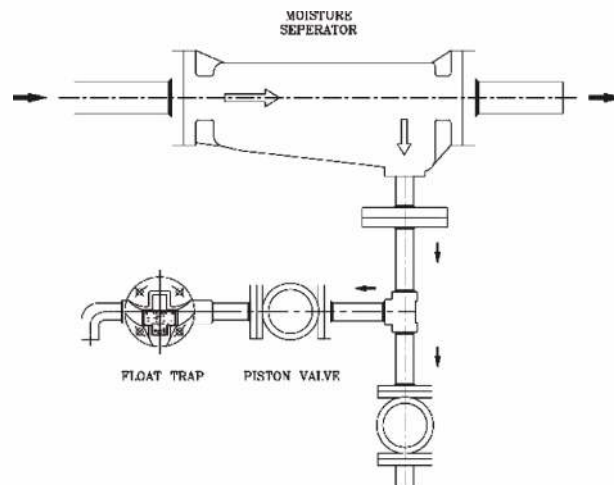

Moisture Separator with float trap drain module



# [ SLSEP - 25 ] MOISTURE SEPARATOR

## DIMENSIONS

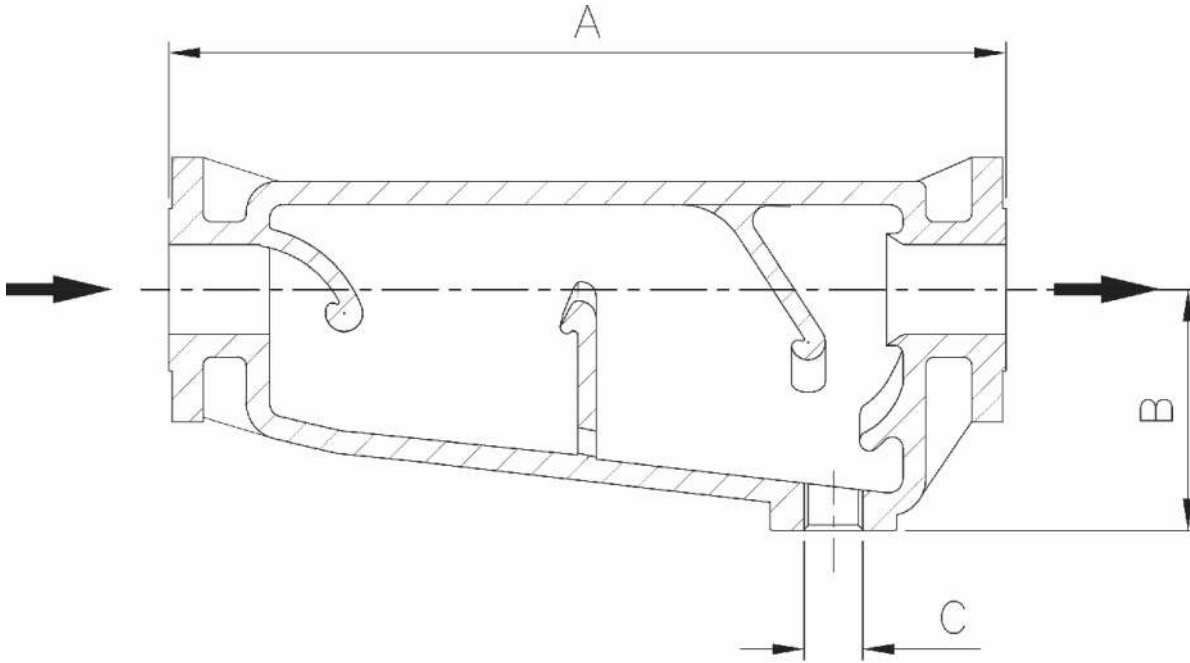

SR. No.	SIZE	Flanged End		B	C (BSPT)
		#150	#300		
1	25 NB	305	311	95	1/2"
2	40 NB	376	383	110	3/4"
3	50 NB	456	462	150	1"
4	65 NB	441	470	180	1"
5	80 NB	494	512	185	1"
6	100 NB	696	712	234	1"
7	125 NB	702	724	236	1"
8	150 NB	702	724	245	1"
9	200 NB	768	794	307	1"

## HOW TO ORDER

Ex. SLSEP-25, Cast Steel,  
Moisture Separator, 50NB, ASA150,  
Non - IBR / IBR



### Steamlok Engineering Private Limited

Factory : W75, S-Block, MIDC Bhosari, Pune (MH) 411 026, India  
Email : sales@steamlokengineering.com  
Web : www.steamlok.com | www.steamlok.co.in